

# ACT2007-8 - Hilton Single Lever Mixertap

abode

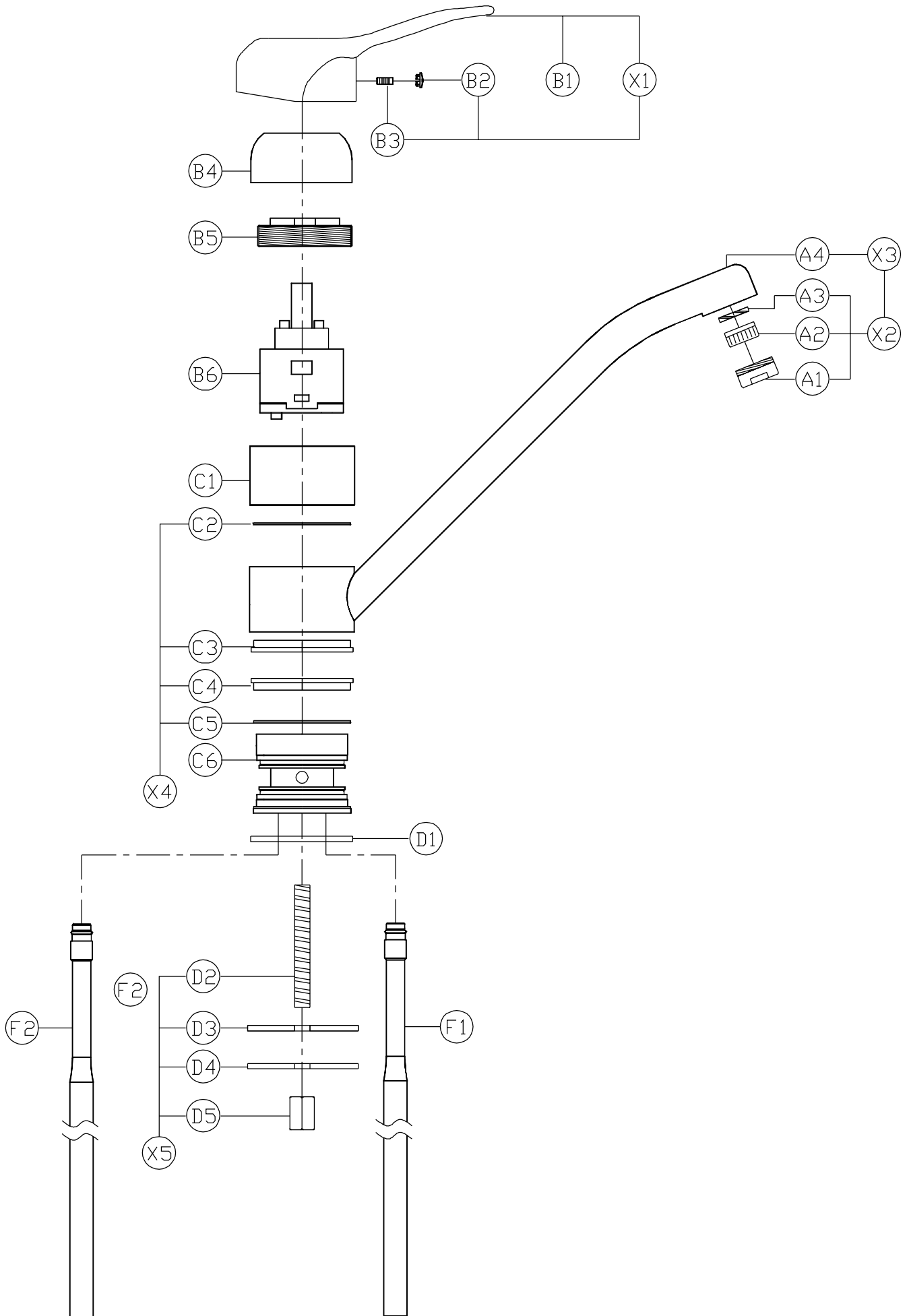

# ACT2007-8 - Hilton Single Lever Mixertap

abode

## General Advice:

- These instructions are intended as a guide only, if you are in any doubt you should seek the advice of a qualified professional.
- Take care not to mark finished parts with screwdrivers or other tools.
- Use a pair of rubber gloves to get a better grip on decorative hand tight parts.
- Ensure all parts are reassembled tightly.
- After maintenance test that all assemblies are water tight and function correctly.
- Always isolate the hot and cold water supplies before starting any maintenance, once isolated you should drain any residual water from your system.

## To replace the valve:

1. Tilt the handle (B1) into the on position.
2. Remove the dust cap (B2) with a fingernail or small screwdriver.
3. Loosen grub screw (B3) using a 2.5mm A/F Allen key.
4. Pull the handle (B1) horizontally away from the tap.
5. Unscrew by hand the decorative cover (B4)
6. Hold the body of the tap (C1) firmly. Using an adjustable spanner unscrew the valve lock nut (B5).
7. Pull the old valve cartridge (B6) away from the tap.
8. Ensure that the valve chamber (C1) is clean of dirt and grit.
9. Place the new valve (B6) in the chamber (C1), ensuring the locators on the base of valve (B6) align with the recesses in the chamber of the tap (C1).
10. Reassemble the tap in the reverse order.
11. If replacing the valve it would be prudent to clean the aerator also.

## To replace the spout o-rings:

1. Hold section (C1) firmly and unscrew it anticlockwise proceed to step 5, Otherwise follow steps 2 to 5.
2. Disconnect tail pipes (F1 & F2) from the supply pipes.
3. Unscrew fixing nut (D5). Pull the tap upwards away from the taphole.
4. Place a spanner across the base of body inner (C6) or the top of both tail pipes (F1 & F2) and unscrew anticlockwise section (C1).
5. Pull the spout (A4) vertically away from the body (C6).
6. Remove the old o-rings (C3 & C4) using a small screwdriver or similar. Note the orientation of the o-rings for reassembly.
7. If worn, remove the white PTFE spacers (C2 & C5).
8. Ensure the inside of the spout (A4) and the body (C6) is clean of dirt and grit.
9. If required locate the new white PTFE spacers (C2 & C5).
10. Carefully locate the new O-rings (C3 & C4) onto the body (C6).
11. Grease the O-rings thoroughly with silicone or alternative similar grease.
12. Reassemble the tap in the reverse order.

## To clean the aerator:

1. Holding the spout (A4) using an adjustable or 22mm spanner unscrew the aerator case (A1)
2. Push the aerator (A2) out from the centre of the aerator case (A1)
3. Using a cloth wipe away any debris from the meshed screens of the aerator (A2)
4. Run warm water through the aerator (A2) held in the backwards direction (inwards from dark grey side)
5. If the aerator (A2) is blocked due to Limescale deposits, we recommend soaking the aerator in vinegar to loosen the scale, then repeat steps 3 and 4.
6. Reassemble the tap in the reverse order.